

GLOUCESTER COUNTY SURVEY MARK DATA SHEET

STATION NO.
094

HORIZONTAL DATA :		
VA. STATE PLANE COORD. - SOUTH ZONE (NAD 1983)		
UNITS	EASTING (X)	NORTHING (Y)
METERS	3678031.638	1132084.508
U.S. SURVEY FT.	12067008.799	3714180.590
LATITUDE (DMS)		37 30 23.17185
LONGITUDE (DMS)		76 29 10.38239
SCALE FACTOR		0.99994833
CONVERGENCE \sphericalangle (DMS)		1 13 19.97
VERTICAL DATA :		
REF. TO NATL. GEOD. VERT. DATUM (1988)		
UNITS	STATION ELEVATION	
METERS	12.88	
U.S. SURVEY FT.	42.27	

STATION DESCRIPTION :

DISTRICT : PETSWORDH

A 3-1/4" ALUMINUM DISK MONUMENT SET APPROXIMATELY FLUSH WITH THE GROUND STAMPED STATION NO. 094. TO REACH: FROM THE INTERSECTION OF STATE ROUTE 602 AND STATE ROUTE 198 AT DUTTON, GO ABOUT 1.3 MILES NORTHWEST ON STATE ROUTE 198 TO MONUMENT SITE; MONUMENT IS 0.15 MILE NORTHWEST OF INTERSECTION OF STATE ROUTE 198 AND STATE ROUTE 674.

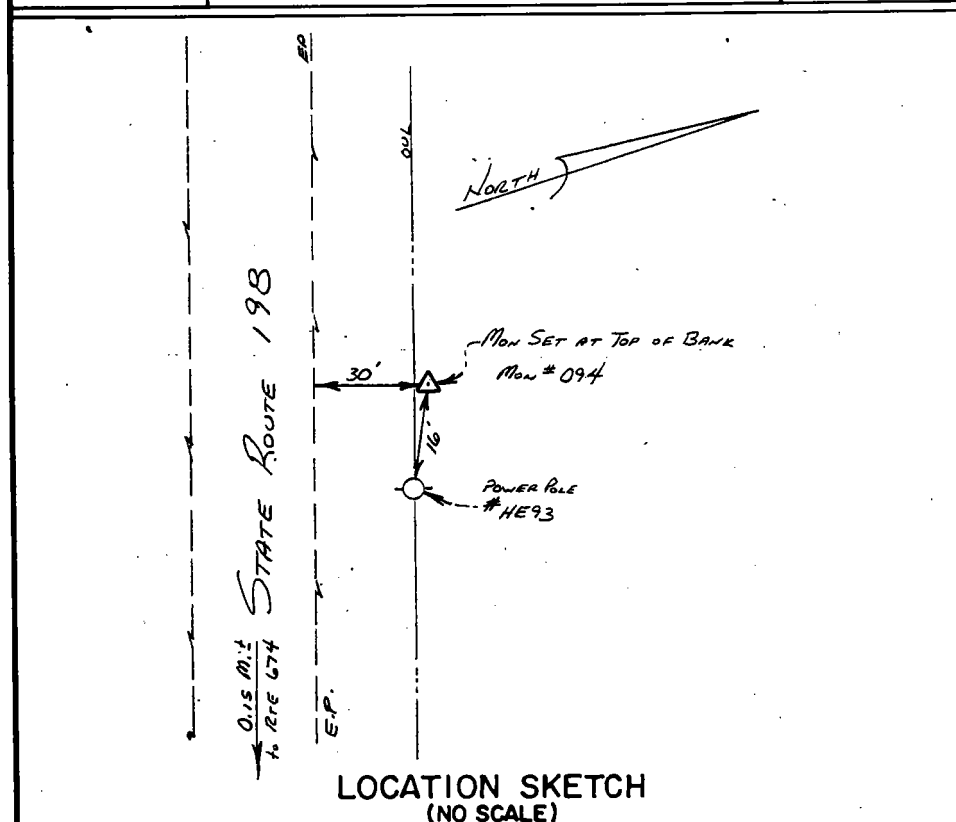

LOCATION SKETCH
(NO SCALE)

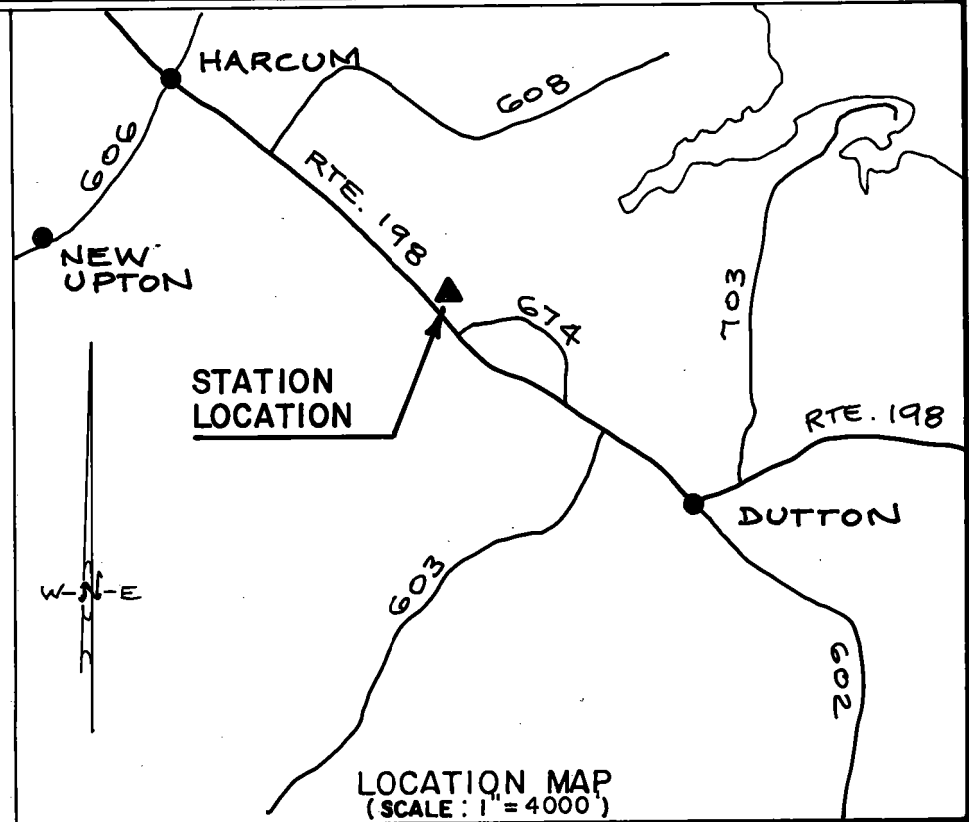

LOCATION MAP
(SCALE: 1" = 4000')

DATE: JANUARY, 1992

NOTE: USERS OF MONUMENTS LOCATED ON PRIVATE PROPERTY
MUST OBTAIN LAND OWNERS PERMISSION BEFORE ENTERING



DAWSON & PHILLIPS, D.C.
CERTIFIED LAND SURVEYORS
(804) 693-2993