

# GLOUCESTER COUNTY SURVEY MARK DATA SHEET

**STATION NO.**

080

HORIZONTAL DATA :		
VA. STATE PLANE COORD. - SOUTH ZONE (NAD 1983)		
UNITS	EASTING (X)	NORTHING (Y)
METERS	3663364.671	1122810.233
U.S. SURVEY FT.	12018888.925	3683753.239
LATITUDE (DMS)		37 25 32.11963
LONGITUDE (DMS)		76 39 14.85942
SCALE FACTOR		0.99994591
CONVERGENCE $\sphericalangle$ (DMS)		1 7 13.10
VERTICAL DATA :		
REF. TO NATL. GEOD. VERT. DATUM (1988)		
UNITS	STATION ELEVATION	
METERS	8.88	
U.S. SURVEY FT.	29.12	

**STATION DESCRIPTION :**

**DISTRICT :** PETSWORTH

A 3-1/4" ALUMINUM DISK MONUMENT SET APPROXIMATELY FLUSH WITH THE GROUND STAMPED STATION NO. 080. TO REACH: FROM THE INTERSECTION OF U. S. ROUTE 17 AND STATE ROUTE 613, GO ABOUT 3.25 MILES SOUTHWEST ON STATE ROUTE 613 TO THE INTERSECTION OF STATE ROUTE 613 AND STATE ROUTE 610; CONTINUE SOUTHWEST ON STATE ROUTE 613 APPROXIMATELY 1.2 MILES TO MONUMENT SITE.

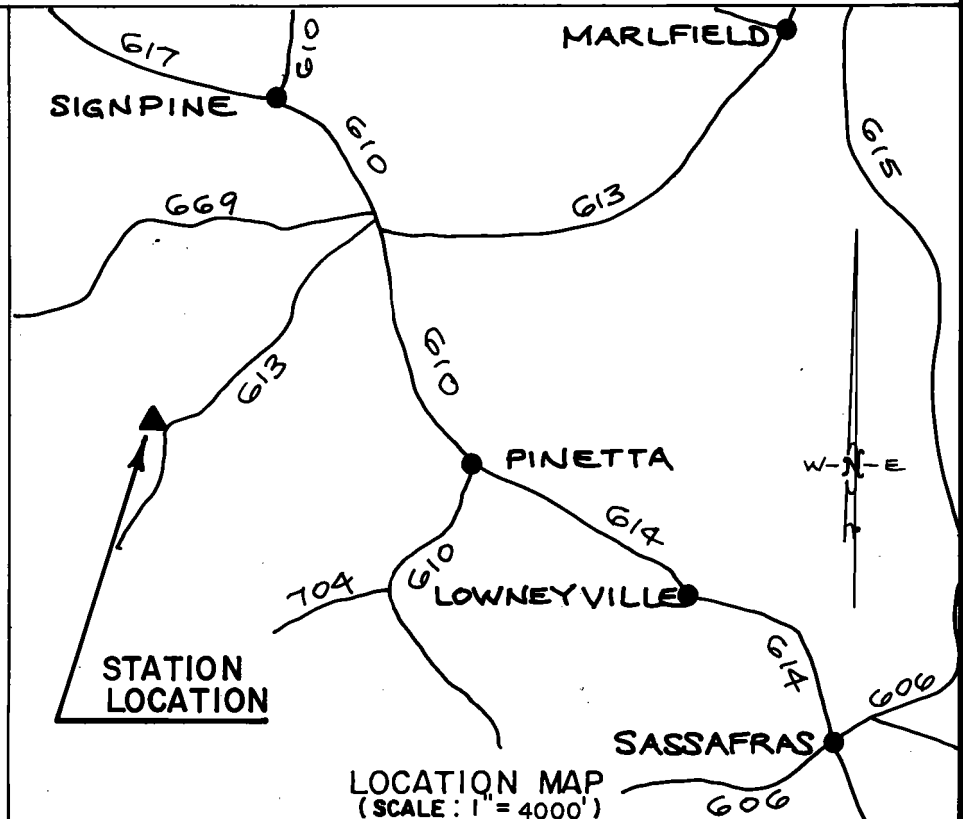
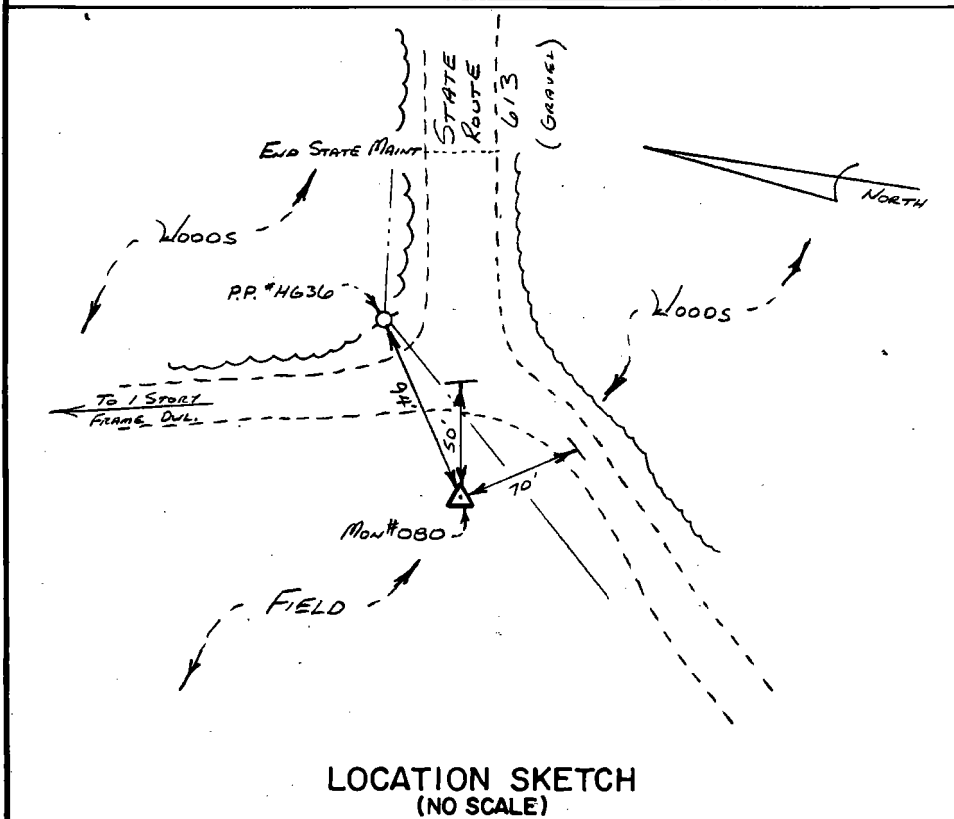

DATE: JANUARY, 1992

NOTE: USERS OF MONUMENTS LOCATED ON PRIVATE PROPERTY  
MUST OBTAIN LAND OWNERS PERMISSION BEFORE ENTERING



**DAWSON & PHILLIPS, P.C.**  
CERTIFIED LAND SURVEYORS  
(804) 683-2993