

# GLOUCESTER COUNTY SURVEY MARK DATA SHEET

**STATION NO.**  
077

HORIZONTAL DATA :		
VA. STATE PLANE COORD. - SOUTH ZONE (NAD 1983)		
UNITS	EASTING (X)	NORTHING (Y)
METERS	3667662.745	1127053.831
U.S. SURVEY FT.	12032990.189	3697675.777
LATITUDE (DMS)		37 27 46.98508
LONGITUDE (DMS)		76 36 16.60896
SCALE FACTOR		0.99994679
CONVERGENCE $\sphericalangle$ (DMS)		1 9 1.29
VERTICAL DATA :		
REF. TO NATL. GEOD. VERT. DATUM (1988)		
UNITS	STATION ELEVATION	
METERS	29.29	
U.S. SURVEY FT.	96.10	

**STATION DESCRIPTION :**

**DISTRICT :** PETSORTH

A 3-1/4" ALUMINUM DISK MONUMENT SET APPROXIMATELY FLUSH WITH THE GROUND STAMPED STATION NO. 077. TO REACH: FROM THE INTERSECTION OF U. S. ROUTE 17 AND STATE ROUTE 610 AT WOODS CROSS ROADS, GO ABOUT 1.29 MILES SOUTHEAST ON U. S. ROUTE 17 TO MONUMENT SITE ON WEST SIDE OF U. S. ROUTE 17 AT PETSORTH SCHOOL.

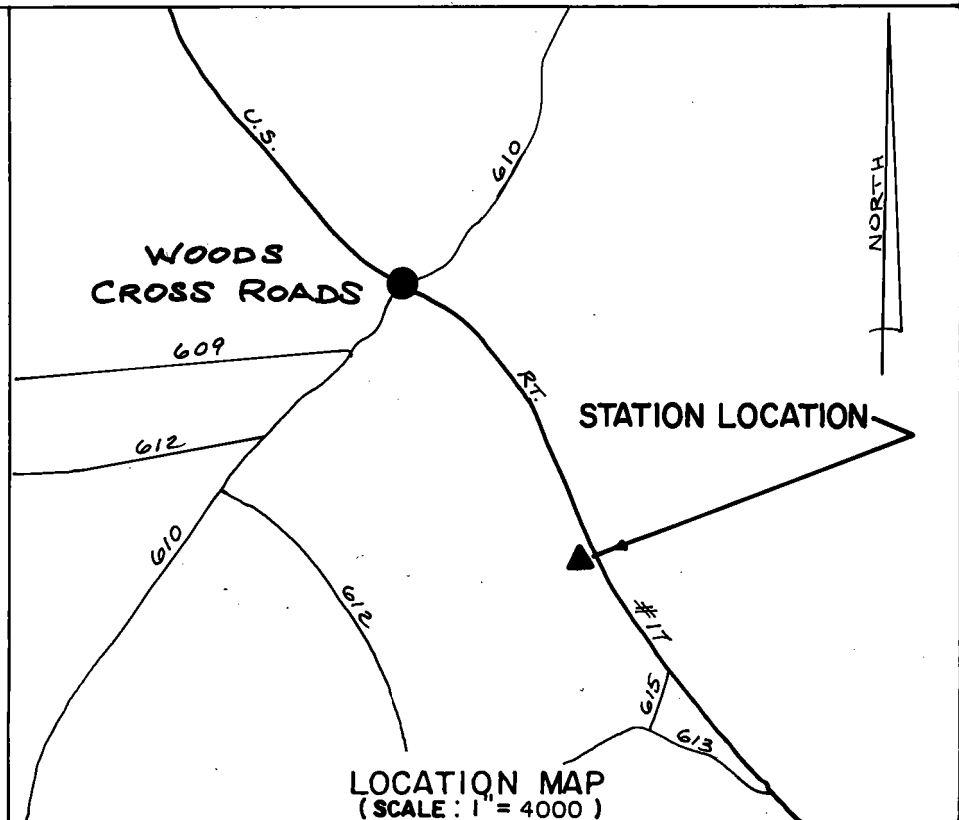
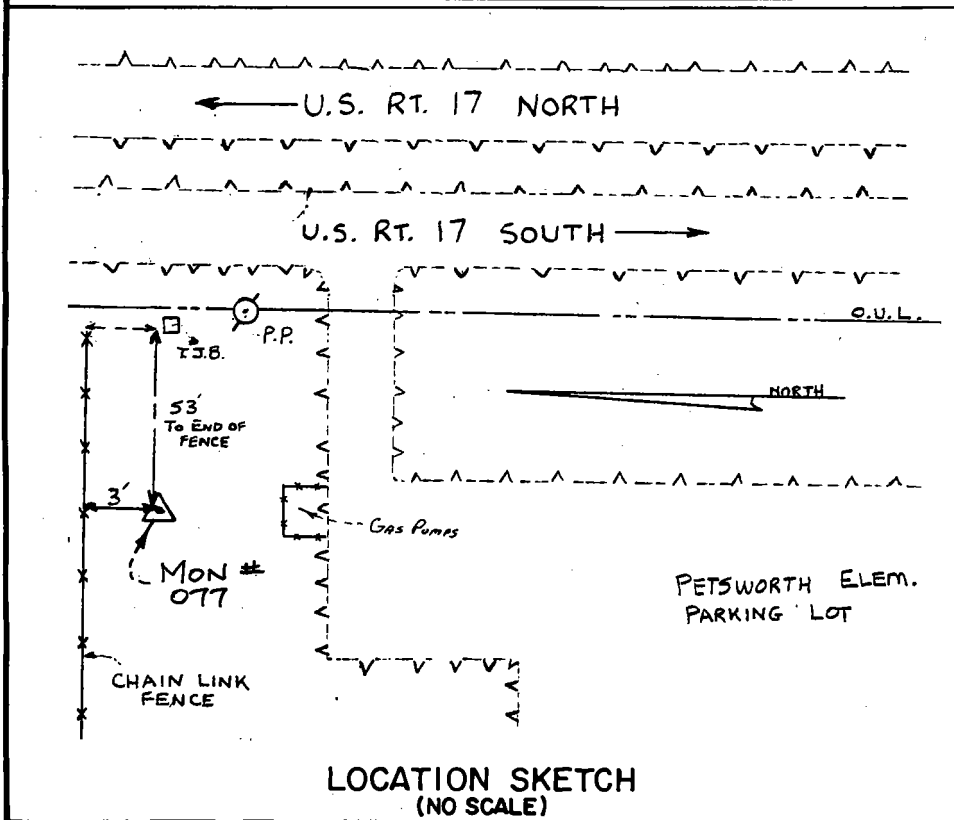

DATE: JANUARY, 1992

NOTE: USERS OF MONUMENTS LOCATED ON PRIVATE PROPERTY  
MUST OBTAIN LAND OWNERS PERMISSION BEFORE ENTERING



**DAWSON & PHILLIPS, D.C.**  
CERTIFIED LAND SURVEYORS  
(804) 693-2993