

GLOUCESTER COUNTY SURVEY MARK DATA SHEET

STATION NO.

074

HORIZONTAL DATA : VA. STATE PLANE COORD. - SOUTH ZONE (NAD 1983)		
UNITS	EASTING (X)	NORTHING (Y)
METERS	3672349.406	1130489.616
U.S. SURVEY FT.	12048366.343	3708948.015
LATITUDE (DMS)	37 29 35.31676	
LONGITUDE (DMS)	76 33 3.04218	
SCALE FACTOR	0.99994780	
CONVERGENCE \sphericalangle (DMS)	1 10 58.77	
VERTICAL DATA : REF. TO NATL. GEOD. VERT. DATUM (1988)		
UNITS	STATION ELEVATION	
METERS	33.74	
U.S. SURVEY FT.	110.70	

STATION DESCRIPTION :

DISTRICT : PETSORTH

A 3 1/4" ALUMINUM DISK MONUMENT SET APPROXIMATELY FLUSH WITH THE GROUND STAMPED STATION NO.074. TO REACH: FROM THE INTERSECTION OF STATE ROUTE 198 AND STATE ROUTE 606 AT HARCUM, GO ABOUT 2.7 MILES SOUTHWEST ON STATE ROUTE 606 TO INTERSECTION OF STATE ROUTE 606 AND STATE ROUTE 607, CONTINUE ABOUT 0.55 MILES WEST ON STATE ROUTE 607 TO MONUMENT SITE.

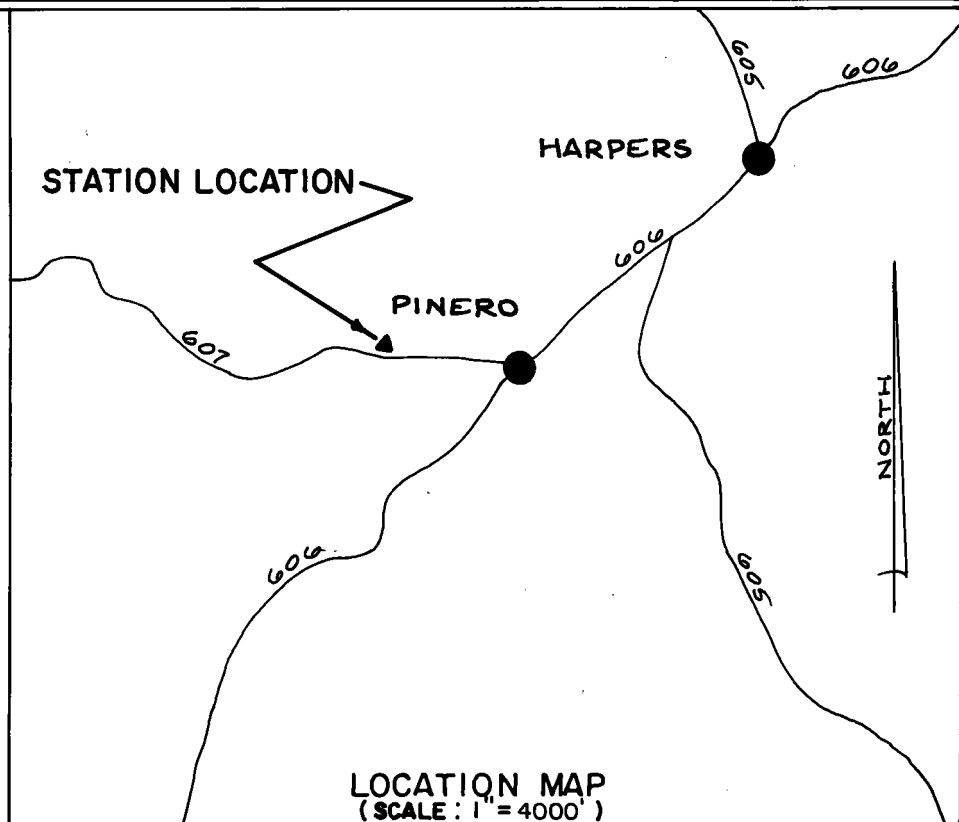
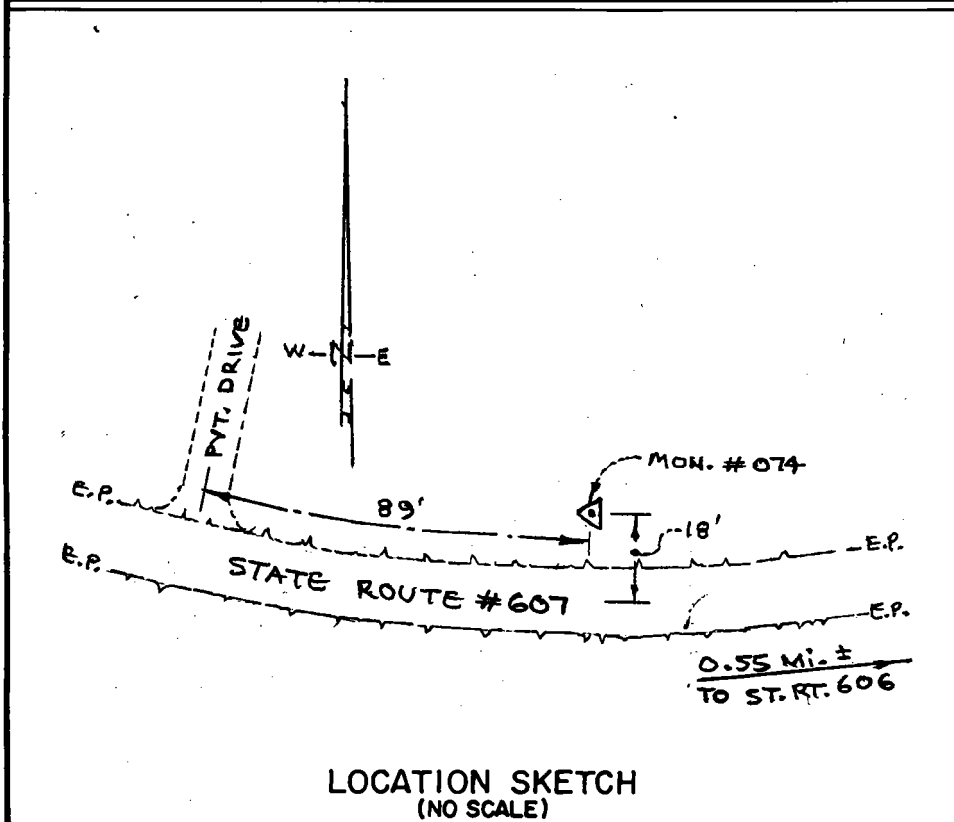

DATE: JANUARY, 1992

NOTE: USERS OF MONUMENTS LOCATED ON PRIVATE PROPERTY
MUST OBTAIN LAND OWNERS PERMISSION BEFORE ENTERING



DAWSON & PHILLIPS, P.C.
CERTIFIED LAND SURVEYORS
(804) 693-2993