

# GLOUCESTER COUNTY SURVEY MARK DATA SHEET

**STATION NO.**  
073

HORIZONTAL DATA :		
VA. STATE PLANE COORD. - SOUTH ZONE (NAD 1983)		
UNITS	EASTING (X)	NORTHING (Y)
METERS	3674632.924	1123163.003
U.S. SURVEY FT.	12055858.185	3684910.619
LATITUDE (DMS)		37 25 36.16740
LONGITUDE (DMS)		76 31 36.33303
SCALE FACTOR		0.99994593
CONVERGENCE $\sphericalangle$ (DMS)		1 11 51.39
VERTICAL DATA :		
REF. TO NATL. GEOD. VERT. DATUM (1988)		
UNITS	STATION ELEVATION	
METERS	10.93	
U.S. SURVEY FT.	35.85	

**STATION DESCRIPTION :**

**DISTRICT :** WARE

A 3-1/4" ALUMINUM DISK MONUMENT SET APPROXIMATELY FLUSH WITH THE GROUND STAMPED STATION NO. 073. TO REACH: FROM GLOUCESTER COURT HOUSE IN THE COURT CIRCLE ON "MAIN STREET" (U. S. ROUTE 17, BUSINESS), GO ABOUT 0.35 MILE NORTHWEST ON "MAIN STREET" TO THE INTERSECTION WITH STATE ROUTE 616; GO ABOUT 0.8 MILE NORTHEAST ON STATE ROUTE 616 TO THE INTERSECTION WITH STATE ROUTE 1045; GO ABOUT 0.06 MILE EAST ON STATE ROUTE 1045 TO INTERSECTION WITH "KIMBERLY DRIVE"; GO ABOUT 0.1 MILE SOUTHEAST ON "KIMBERLY DRIVE" TO MONUMENT SITE ON SOUTHEAST CORNER OF INTERSECTION WITH "SPRING COURT".

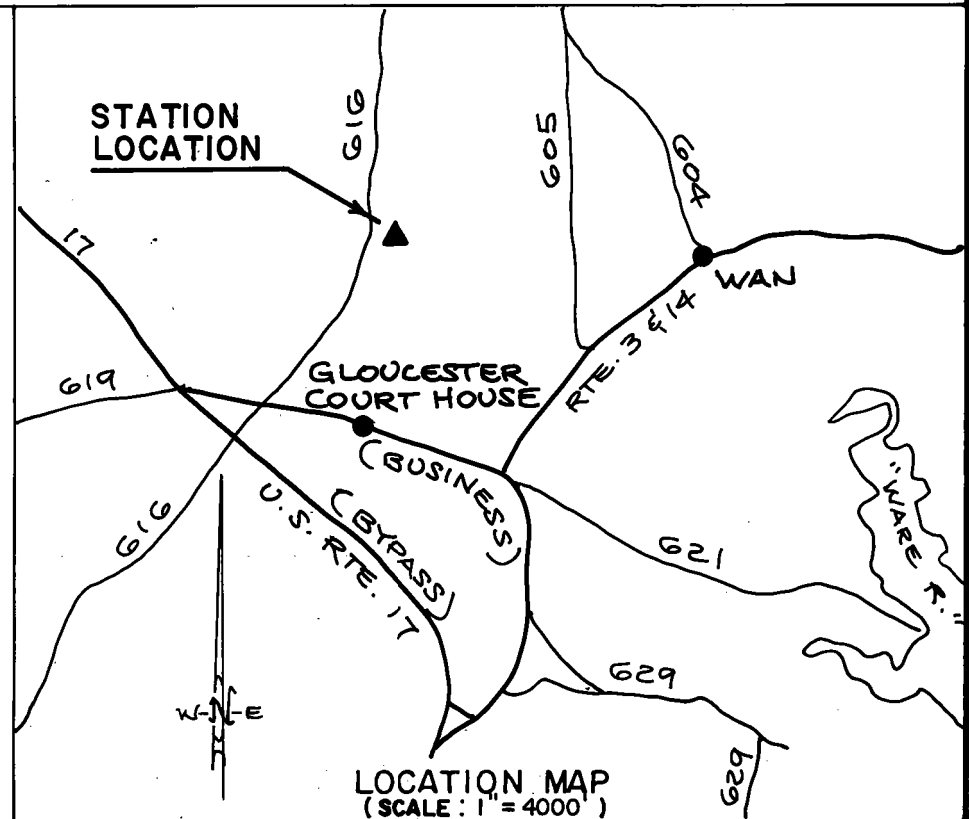
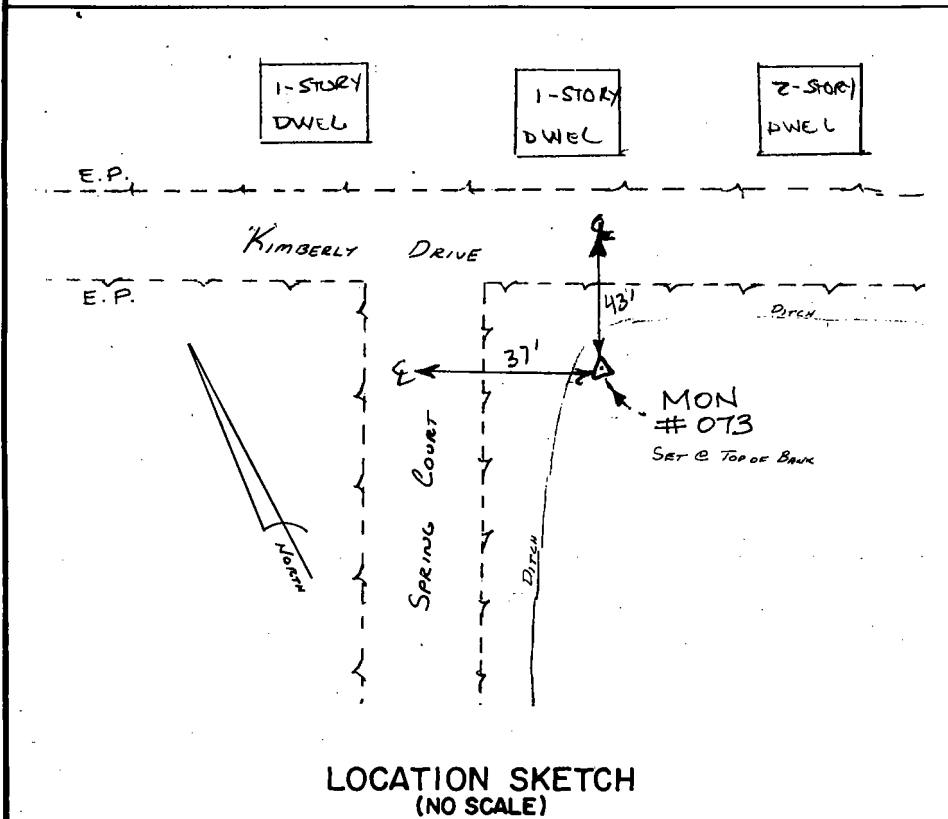

DATE: JANUARY, 1992

NOTE: USERS OF MONUMENTS LOCATED ON PRIVATE PROPERTY  
MUST OBTAIN LAND OWNERS PERMISSION BEFORE ENTERING



**DAWSON & PHILLIPS, P.C.**  
CERTIFIED LAND SURVEYORS  
(804) 693-2993